



**ONOWAY
JUNIOR/SENIOR
HIGH SCHOOL**

EMPOWERING LEARNERS



Northern Gateway
Public Schools



New Student Information Document 2017/18

Onoway Junior Senior High School

SCHOOL CONTACT INFORMATION

Onoway Junior Senior High School

Bag 340 Onoway, AB T0E 1V0

Phone: 780.967.2271

Fax: 780.967.2660

Website: onowayhigh.ca/

Twitter: [@ngpsohs](https://twitter.com/ngpsohs)

Email: ohs@ngps.ca



**ONOWAY
JUNIOR/SENIOR
HIGH SCHOOL**

EMPOWERING LEARNERS



**Northern Gateway
Public Schools**

OJSH Grade 8 and 9 Supply List

(Note: Teachers encourage students to reuse materials from previous years)
Students may have up to 6- 8 different teachers in core and optional subjects.

General	Specific to a classes
<p>Binders 2 larger binders- 1 for the am and 1 for the pm OR 5 smaller binders -for each of the 4 core subjects, and one for options</p> <p>Hole punched blank paper - small amount Hole punched lined paper- for all classes Pens (red, blue and black) Pencils Fine Tipped markers Pencil crayons Highlighter Eraser Dividers Dictionary and Thesaurus (for LA/Social)</p> <p>Pencil case 1 liquid correction fluid Reinforcements</p>	<p>For Social Studies: 2 key tabs (32 pages each) Laminated 8 x 11 World and/or Canada map</p> <p>For Math you will require: Geometry set Graph paper - also used in Science Minimum of 2 coil notebooks Duotang 1 keytab notebook Ruler Basic Scientific calculator capable of doing 2 lines -NOT A GRAPHING CALCULATOR Links below with pricing</p> <p>For PE: Non-marking indoor running shoes Shorts and or appropriate pants for PE Full length t-shirt or similar, appropriate for physical activity Lock for Phys. Ed bin lockers</p>

Calculator information

Sharp® EL531XGBWH Scientific Calculator \$16.94

https://www.staples.ca/en/Sharp-EL531XGBWH-Scientific-Calculator/product_922652_2-CA_1_20001

Texas Instruments TI-30XIIS Solar 2-Line Scientific Calculator -\$20.73

https://www.staples.ca/en/Texas-Instruments-TI-30XIIS-Solar-2-Line-Scientific-Calculator/product_382647_2-CA_1_20001

Box 340, Onoway, T0E 1V0
780.967.2271
onowayhigh.ca

Onway Junior-Senior High School Main Floor

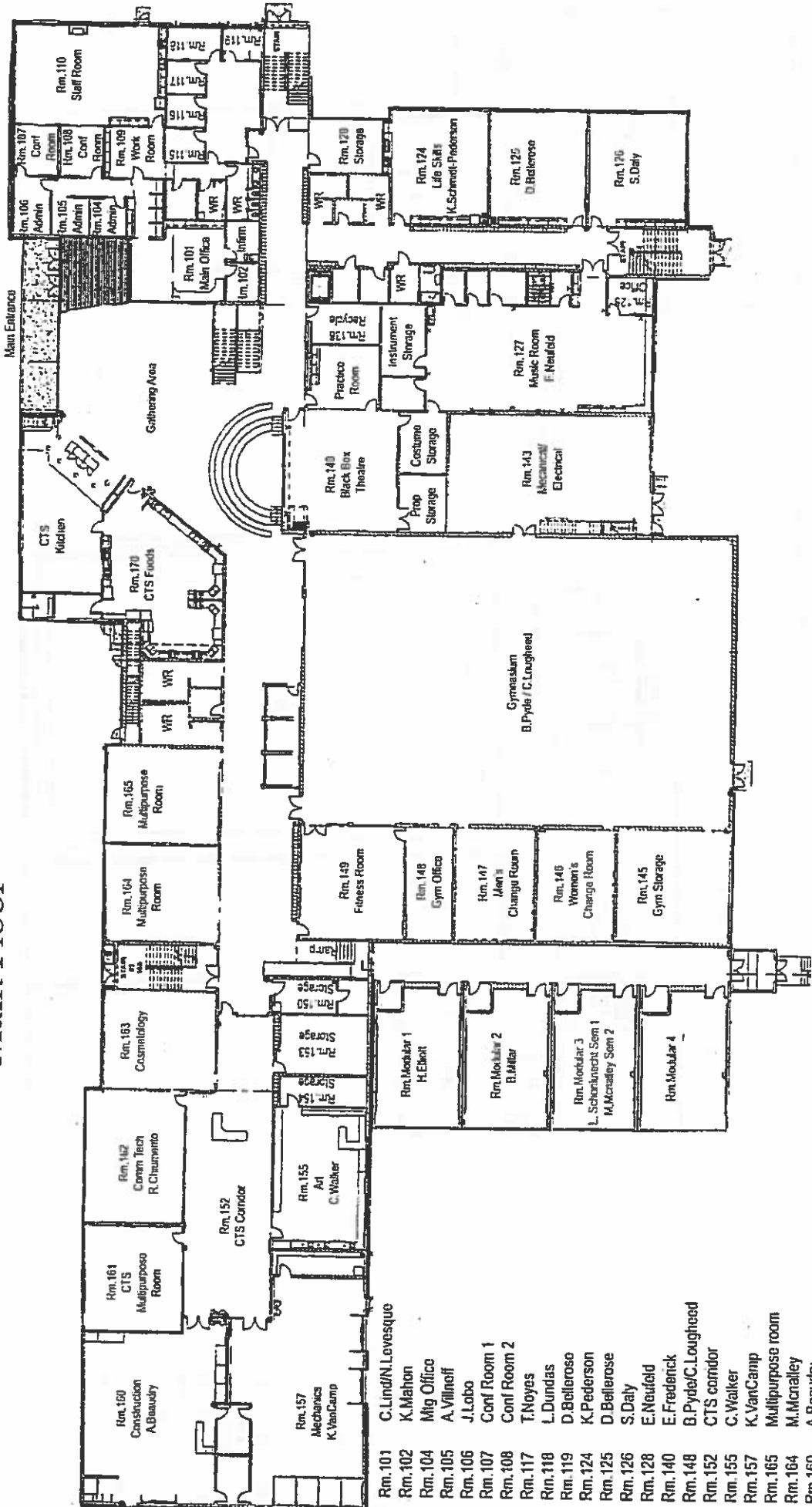

- Rm. 101 C. Lind/N. Lovesque
- Rm. 102 K. Mahon
- Rm. 104 Mig Office
- Rm. 105 A. Villinoff
- Rm. 106 J. Lobo
- Rm. 107 Conf Room 1
- Rm. 108 Conf Room 2
- Rm. 117 T. Noyes
- Rm. 118 L. Dundas
- Rm. 119 D. Bellerose
- Rm. 124 K. Pederson
- Rm. 125 D. Bellerose
- Rm. 126 S. Daly
- Rm. 128 E. Neufeld
- Rm. 140 E. Frederick
- Rm. 148 B. Pyde/C. Loughheed
- Rm. 152 CTS corridor
- Rm. 155 C. Walker
- Rm. 157 K. VanCamp
- Rm. 165 Multipurpose room
- Rm. 164 M. Mcnalley
- Rm. 160 A. Beaudry
- Rm. 161 Ancillary CTS/Science
- Rm. 163 Cosmetology
- Rm. 162 R. Chimento
- Rm. 170 S. Daly/S. Karmaznik
- Rm. Modular 1 H. Elliott
- Rm. Modular 2 B. Miller
- Rm. Modular 3 L. Schonkrecht Sem 1/M. Mcnalley Sem 2
- Rm. Modular 4

Onoway Junior-Senior High School Second Floor

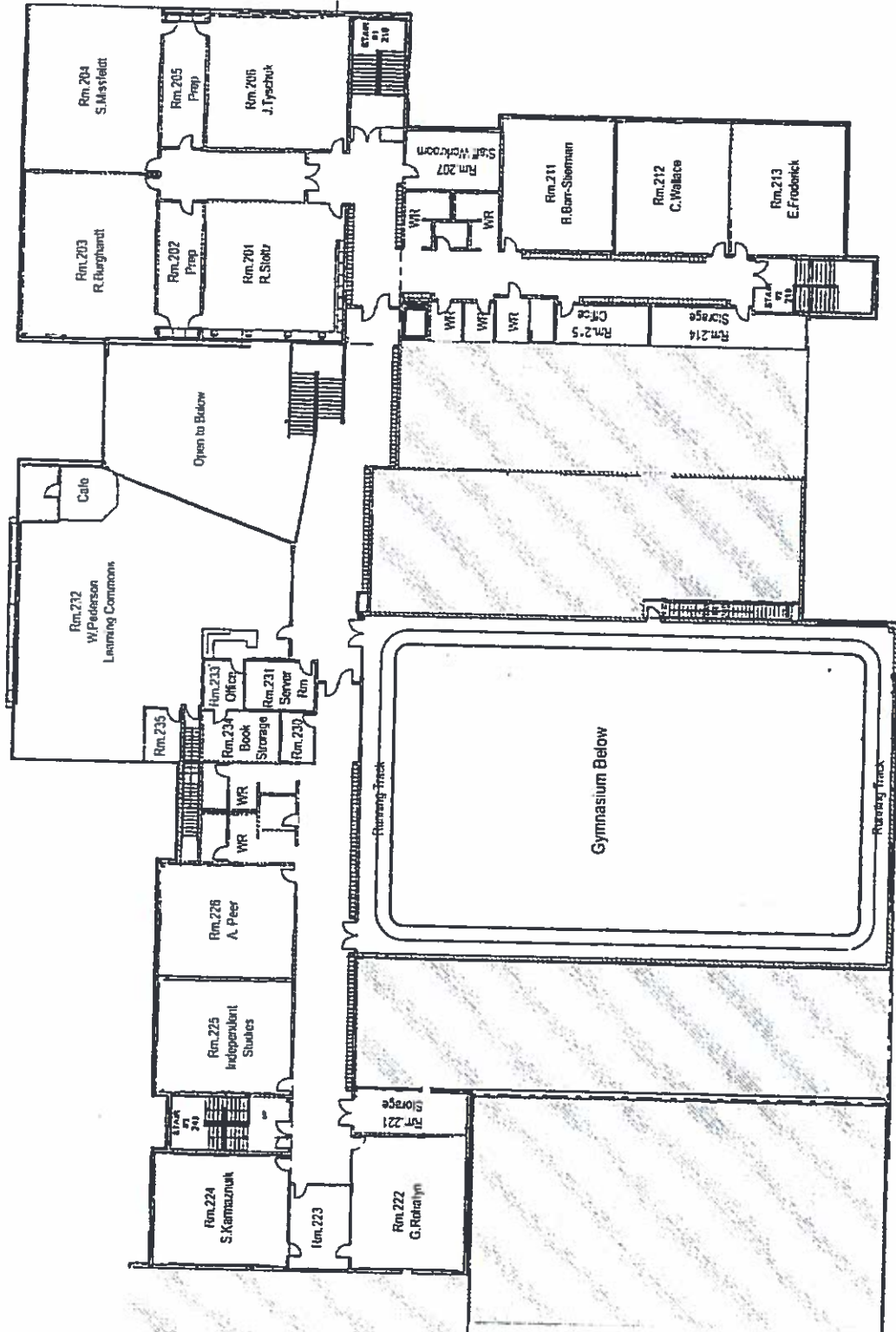

- Rm. 201 R. Stoltz
- Rm. 203 R. Burghardt
- Rm. 204 S. Misfeldt
- Rm. 206 J. Tyschuk
- Rm. 211 B. Barr-Sierman
- Rm. 212 C. Wallace
- Rm. 213 E. Frederck
- Rm. 215 Office
- Rm. 222 G. Rohatyn
- Rm. 223 Breakout Room
- Rm. 224 S. Karmaznuik
- Rm. 226 A. Peer
- Rm. 231 Server Room
- Rm. 232 W. Pederson
- Rm. 235 Maker space storage

ADMINISTRATIVE STAFF



Mr. J. Lobo-
Principal



Mrs. A. Villneff-
Assistant Principal



Ms. C. Lind-
Executive
Administrative
Assistant



Mrs. N. Levesque-
Administrative
Assistant



Mrs. K. Mahon-
Office Accountant

TEACHING STAFF



Ms. E. Anderson
Music



Mrs. B. Barr-
Stierman-English/
Social Studies



Mr. D. Bellerose-
Counsellor/Math/Sp.
Education



Mr. J. Blount
Math



Mr. R. Burghardt-
Chemistry/Science



Mrs. A. Caux
Language Arts



Mr. R. Chiumento-
Info Pro CTS/ Science



Mr. S. Daly-Language
Arts/Social Studies



Mrs. L. Dundas-
Counsellor/CALM



Mr. J. Eastman-
Construction
Technology



Mrs. H. Elliott-
Mathematics



Mr. E. Frederick-
English / Language
Arts/Drama



Mr. S. Karmaznuik-
Foods/English



Mr. C. Loughheed-
Physical Education



Mrs. M. McNalley-
Mathematics



Mr. B. Millar-
Social Studies



Mr. S. Missfeldt-
Physics / Mathematics



Mr. G. Rohatyn-
Social Studies/Science



Ms. K. Schmidt Peterson
Inclusive Ed/French



Mr. R. Seimens
-Mechanics



Mr. R. Stoltz-
Science / Math



Ms. S. Swerda-
Outreach and
Off-Campus
Coordinator



Mrs. J. Tyschuk-
Biology



Mr. K. Van Camp-
Science



Ms. C. Wallace-
Language Arts /
Business



Mrs. C. Walker-
Art

SUPPORT STAFF



Ms. B. Bambrick
Caretaker



Mrs. J. Fownes-
Educational Assistant



Mr. M Galliford-
Kitchen Manager



Mrs. K. Gonnet-
Kitchen Assistant



Mr. R. Huxley-
Educational Assistant



Constable S. Javer-
School Resource
Officer



Mrs. D. Kensington-
Educational Assistant



Mr. Lefebvre
Maintenance

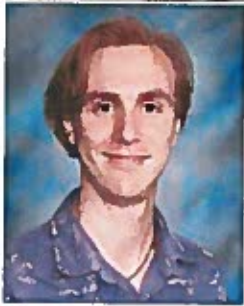

Ms. J. Mahaux
I.T. Tech



Mrs. T. Noyes-
Aboriginal Liaison



Mrs. L. Petherbridge-
Outreach Secretary



Mrs. W. Pederson-
Learning Commons
Librarian



Mrs. H. Sauer-
Head Caretaker
Custodian



Mrs. J. Shewchuk-
Educational Assistant



Mrs. M.J. Vaughan-
Kitchen Assistant

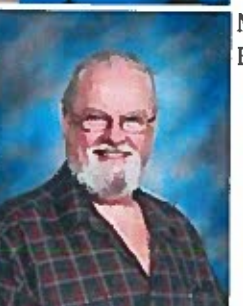

Mr. B. Walker-
Educational Assistant

